

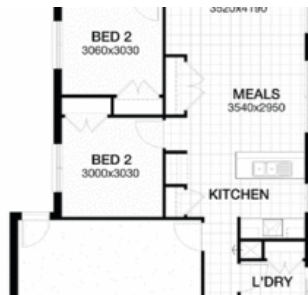

Tarneit



## Tarneit - Great entry opportunity

Tarneit is located 28 km West of Melbourne's CBD. It is an emerging suburb in the City of Wyndham.

It is an opportunity to become part of a vibrant new residential community located minutes to Tarneit train stations.

Designed with an abundance of parks, gardens and open green space, the estate provides an ideal setting for an active and healthy lifestyle, while the beautifully landscaped central wetlands region will provide tranquil views over natural surrounds.

Access to public transport, schools & shopping centres is also very good.

\* Price / Availability subject to change

Please contact us for further information.

The above information provided has been furnished to us by the vendor/s. We have not verified whether or not that information is accurate and do not have any belief in one way or the other in its accuracy. We do not accept any responsibility to any person for its accuracy and do no more than pass it on. All interested parties should make and rely upon their own inquiries in order to determine whether or not this information is in fact accurate.

3 2 2

<b>Price</b>	\$411,400
<b>Property Type</b>	residential
<b>Property ID</b>	37
<b>Land Area</b>	315 m2
<b>Floor Area</b>	167 m2

### Agent Details

Jeany Immanuel - 0410 089 477

### Office Details

Alexandria  
Suite 110 / 488 Botany Road  
Alexandria NSW 2015 Australia  
02 9341 5766

